

## PW0404-100

## UHF Linearly Polarized Antenna

### Features

- ✓ Omni-directional pattern
- ✓ Wide operating temperature range
- ✓ Designed to NASA GEVS (GSFC-STD-7000)
- ✓ TRL 9

### Benefits

- ✓ Commercial off-the-shelf (COTS)
- ✓ Acceptance Tests available
- ✓ Compatible Test Hat available
- ✓ Qualified for space applications
- ✓ Consultation services available (link budget, architecture and system design)



### Product Overview

PW0404-100 is a high-performance antenna designed for high-reliability TT&C applications in harsh space environments. It features excellent pattern and temperature stability, making it ideal for demanding and reliable space communication links.

This antenna is a perfect choice for a variety of space applications, including LEO, MEO and GEO. Specifically, it is designed to overcome challenges present in the LEO environment over long mission lives, such as Corona, Multipaction, Atomic Oxygen, MMOD, etc. The UHF Antenna is lightweight and easy to integrate. It is also available with Test Hats to facilitate testing and integration.

### Related Products

Part Number	Description
PW0404-300	UHF Linearly Polarized Test Hat
PW2022-101	S-Band RHCP Wideband Omni Antenna
PW2022-102	S-Band RHCP Dual-Port (TX+RX) Omni Antenna
PW8282-102	X-Band RHCP TX 2X2 Antenna
PW8282-103	X-Band RHCP TX Switched-Beam Hemispherical Antenna Module
PW1515-004	Active GNSS L1/E1 Antenna

Information furnished by PlaneWave, Inc. is believed to be accurate and reliable. However, no responsibility is assumed by PlaneWave for its use, nor for any infringements of patents or other rights of third parties that may result from its use.

## Electrical Specifications

Parameter / Condition	Min	Typ	Max	Unit
Operating Frequency	395		405	MHz
Polarization		Linear		
VSWR		2:1	3.6:1	
Gain	-1	0.5	1	dBi
Pattern Coverage		Omni		
Power Handling	20			W

## Mechanical Specifications

Parameter / Condition	Value	Unit	Limits
Connector	SMA Female		
Mass	630	g	Max
Compatible Test Hat	PW0404-300		

## Environmental Specifications

Parameter / Condition	Min	Typ	Max	Unit
Operating Temperature	-70		100	°C
Humidity (MIL-STD-810 Method 507.6)	65%			
Storage Temperature	-70		100	°C
Vibration	14.1			G <sub>RMS</sub>

Random Vibration Test Levels  
(GSFC-STD-7000)

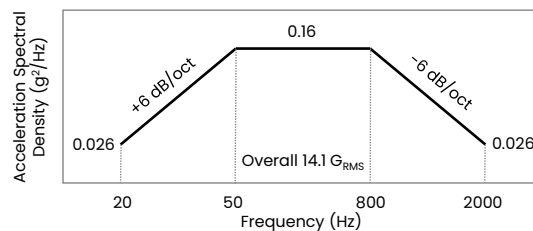

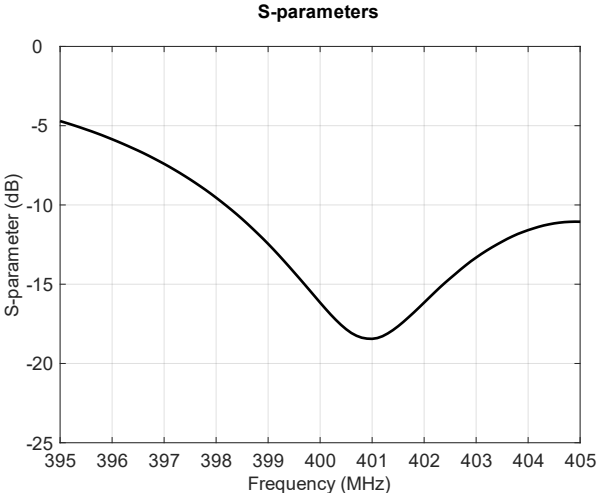
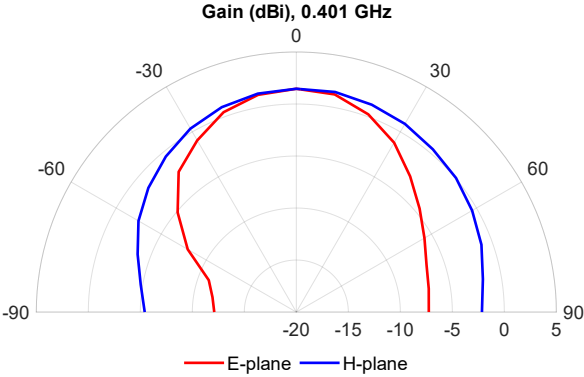
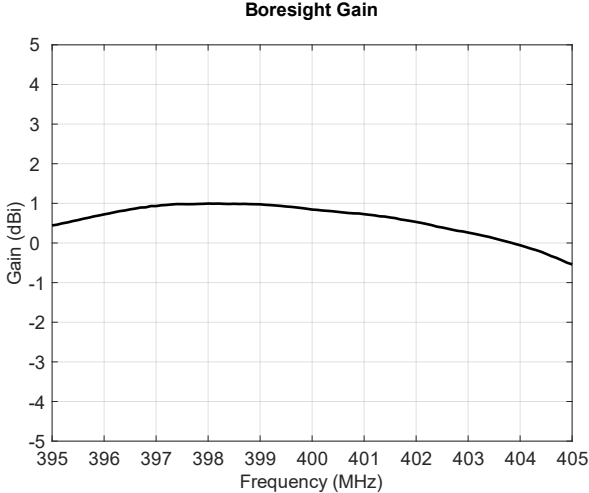

**Mechanical Outline**

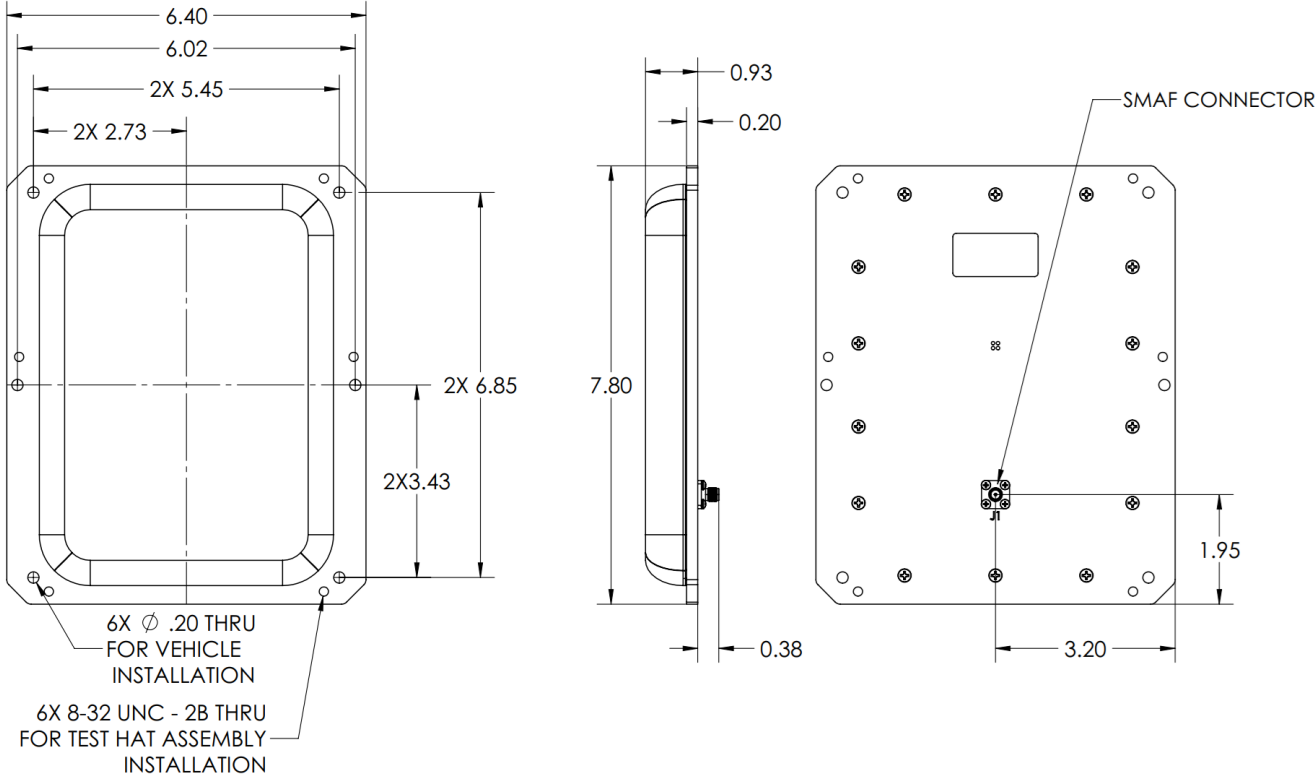

**Dimensions shown in inches.**  
Tolerances - Two Place Decimal: ±0.010, Three Place Decimal: ±0.005

**Contact PlaneWave, Inc.**

6925 Canby Ave, Ste 110  
Reseda, CA 91335

[www.planewaveinc.com](http://www.planewaveinc.com)  
[sales@planewaveinc.com](mailto:sales@planewaveinc.com)