

PW3017-100 K-Ka-Band Dual-Port (RHCP+LHCP) Waveguide Probe

Features

- ✓ Broadband
- ✓ Shared aperture with separate RHCP and LHCP ports
- ✓ Excellent port to port isolation
- ✓ Extremely durable

Benefits

- ✓ Commercial off-the-shelf (COTS)
- ✓ Customization available



Product Overview

PW3017-100 is an open ended waveguide antenna that combines small size with high accuracy. It includes two 2.92mm connectors, one for RHCP polarization and the other one for LHCP. Due to the broadband operation of both ports from 17 to 30 GHz, this probe is suitable for use on either side of the SATCOM link: space or ground.

This antenna is a perfect choice for a variety of RF laboratory applications, including antenna ranges, emerging wireless technology link setups and more.

Related Products

Part Number	Description
PW3017-115	K-Ka-Band Dual-Port (RHCP+LHCP) Horn Antenna, 15 dB
PW3017-120	K-Ka-Band Dual-Port (RHCP+LHCP) Horn Antenna, 20 dB
PW4018-100	Dual-Ridged Horn Antenna, 18-40 GHz
PW4010-101	Quad-Ridged Horn Antenna, 10-40 GHz

Information furnished by PlaneWave, Inc. is believed to be accurate and reliable. However, no responsibility is assumed by PlaneWave for its use, nor for any infringements of patents or other rights of third parties that may result from its use.

Electrical Specifications

Parameter / Condition	Min	Typ	Max	Unit
Operating Frequency	17		30	GHz
Polarization		RHCP/LHCP		
VSWR			2:1	
Gain	6		10	dBic
Power Handling (CW)			20	W
Operating Temperature	-40		85	°C

Mechanical Specifications

Parameter / Condition	Value	Unit	Limits
Connector	2.92 mm Female		
Mass	60	g	Max

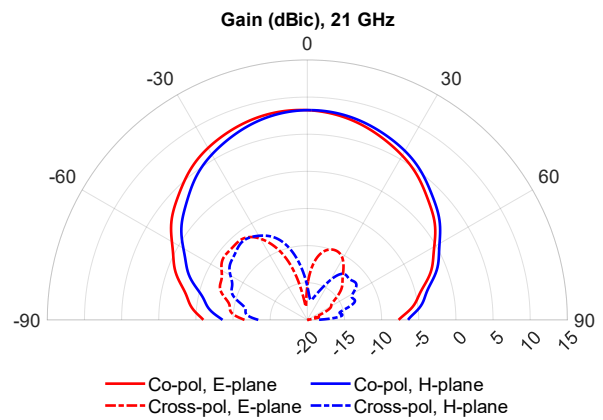
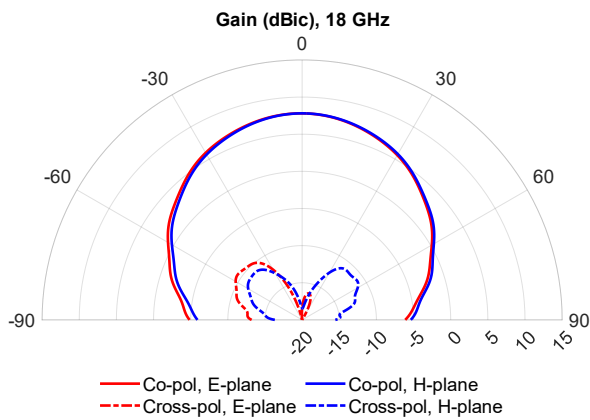

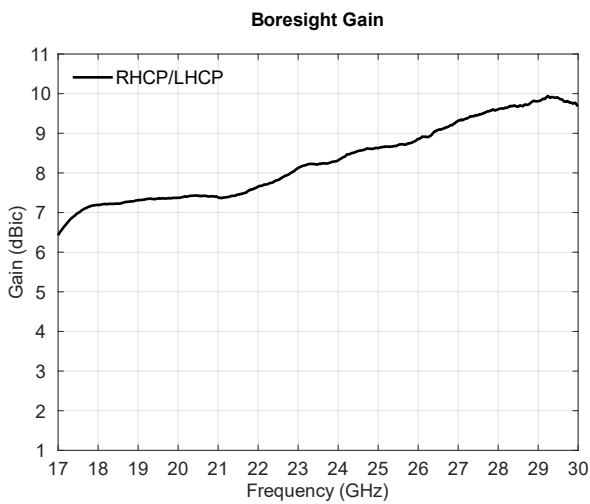
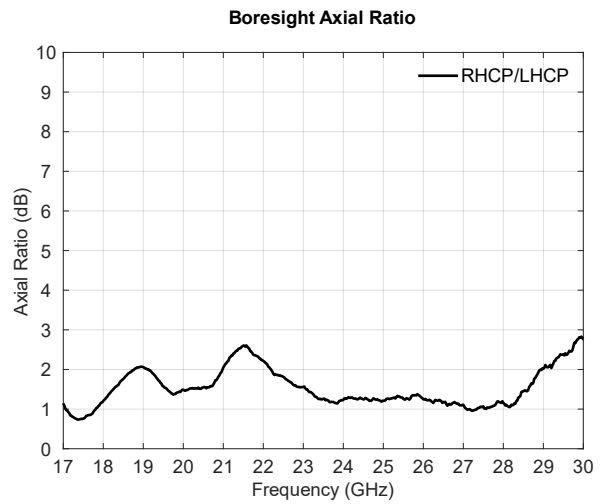
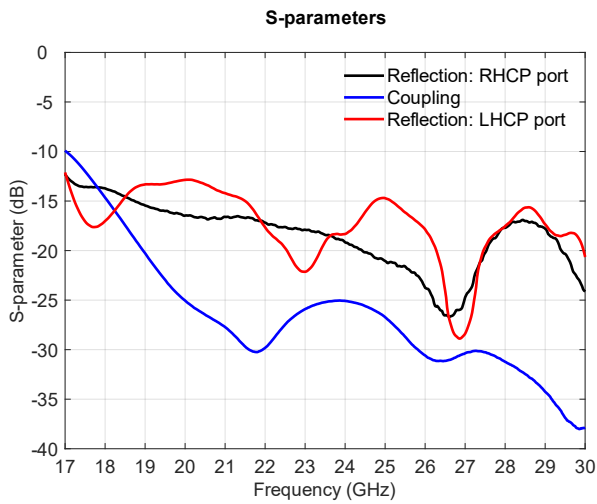
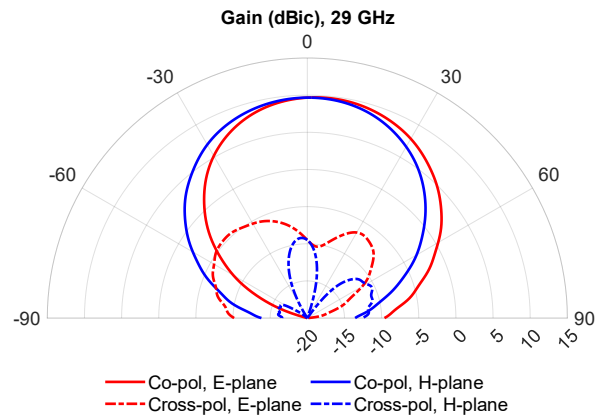
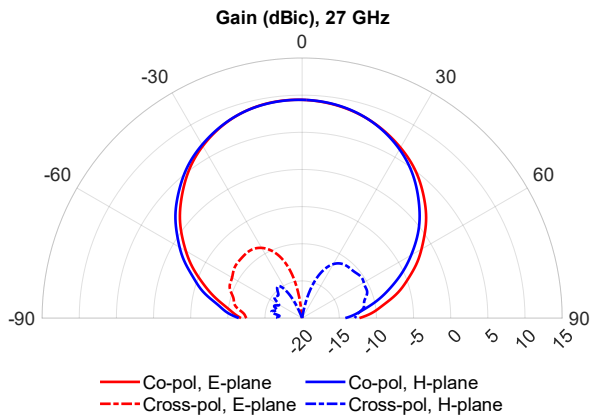

Mechanical Outline

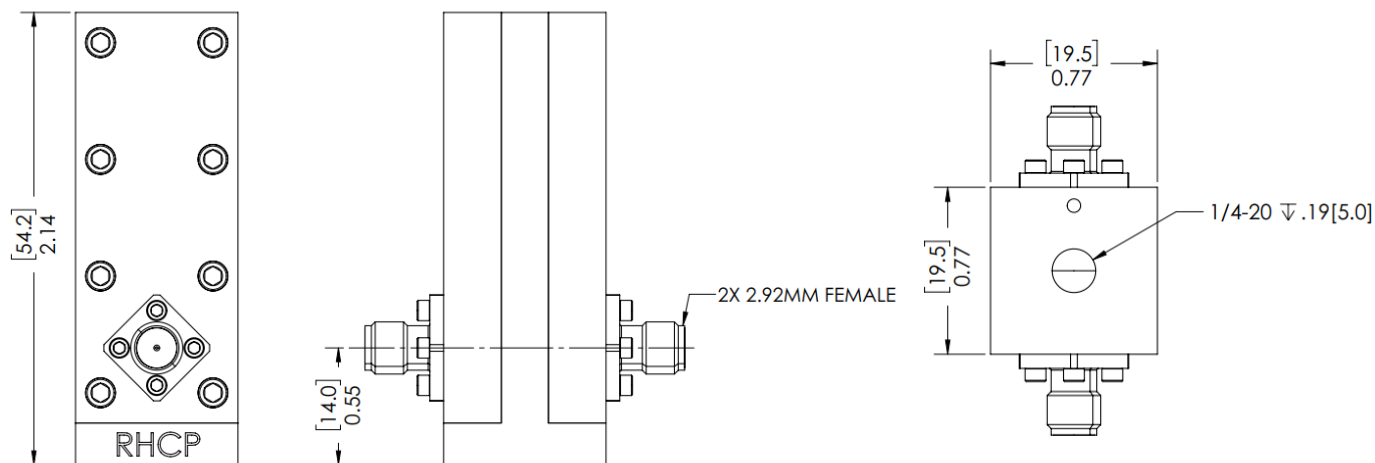

Dimensions shown in inches [millimeters]

Tolerances in millimeters - Integer: ±3, One Place Decimal: ±0.1, Two Place Decimal: ±0.05

Contact PlaneWave, Inc.

6925 Canby Ave, Ste 110
Reseda, CA 91335

www.planewaveinc.com
sales@planewaveinc.com